

# Initial Addressing of a Rako Receiver Module

## Step 1

Set address switches on controller

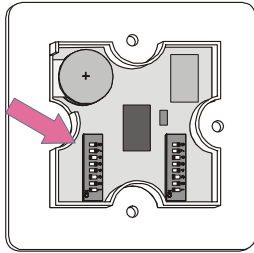

Pick House address from 1-255  
(keep same address for all panels in house)  
Select Room addresses from 1-255 for each room (Room 0 is master house control)

## Step 2

**TIP**  
Press the scene button first

Put controller into programming mode by pressing and holding a scene button and both raise and lower buttons together

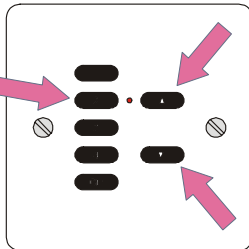

## Step 4

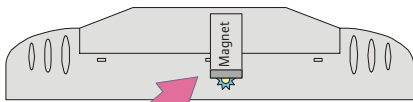

When available channel is found, hold magnet against casing at point indicated on the label until LED illuminates. Hold until LED starts flashing and then remove magnet. Module is now in set-up mode.

## Step 5

Press button 3 to send the ident of the channel selected in step 3. Receiver automatically returns to normal mode

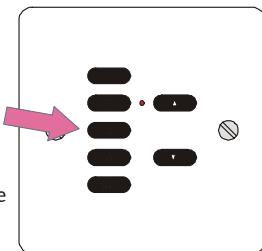

## Step 3

LED starts to flash after 5 seconds, panel is now in programming mode. Use buttons 1 & 2 to scroll to an available channel

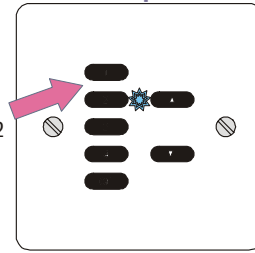

When in programming mode buttons have the following functions for addressing

Button	Action
1	Scroll up and ident
2	Scroll down and ident
3	Ident
4	No action
Off	Exit programming

See details for scrolling

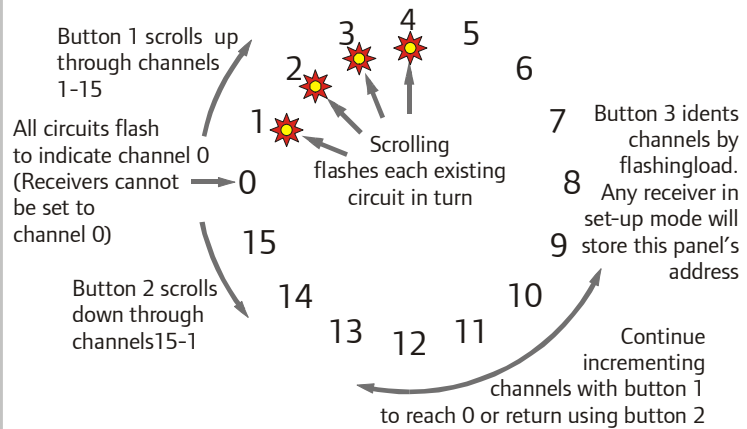

## Step 6

Press Off button to exit controller from programming mode

