

Preset Dimmer
Incandescent/Halogen 240 V
LLSI-502, LNSI-502
Rated at: 220-240 V~ 50 Hz 40-500 W



Incandescent/Halogen 240 V / Magnetic Low Voltage
LLSM-502
Rated at: 220-240 V~ 50 Hz 40-500 VA



Slide To Off Dimmer
Incandescent/Halogen 240 V
LSSI-501
Rated at: 220-240 V~ 50 Hz 40-500 W



Important Notes

Please read before installing.

- WARNING:** Do not use LLSI-502, LNSI-502 or LSSI-501 with magnetic (core and coil) low-voltage transformers or electronic (solid-state) low-voltage transformers.
- Use LLSM-502 only with incandescent loads or magnetic low-voltage transformers with thermally fused primary.
- CAUTION:** To avoid overheating and possible damage to other equipment, do not use to control receptacles, fluorescent lighting fixtures, motor-operated or transformer-supplied appliances.
- Turn power OFF at MCB (circuit breaker) before performing any routine maintenance or servicing of lighting circuit.
- For new installations, install a test switch before installing the Dimmer to verify no short in the wiring.
- Protect Dimmer from dust and dirt when painting or during construction.
- Only one Dimmer can be used in a 2-way circuit.
- Dimmer requires a minimum total lamp wattage of 40 W. Do not exceed the maximum rating of 500 W.
- This Dimmer complies with IEC and EN 60669-2-1.
- Minimum backbox depth is 35 mm.**
- Install in accordance with all national and local electrical codes.
- Operate between 0 °C and 40 °C. For indoor use only.
- Dimmer may not work with dioded lamps.
- It is normal for the Dimmer to feel warm to the touch during operation.
- Clean with a *soft damp cloth only*. **DO NOT** use any chemical cleaners.

Call +44 (0) 207 702 0657
with any questions or feedback
Monday thru Friday 08:00 – 20:00 CET
Saturday and Sunday 10:00 – 20:00 CET

Visit www.lutron.com/europe
for more product information.

Technical Assistance

If you have questions concerning the installation or operation of this product, call **Lutron's European Headquarters**. Please provide exact model number when calling.

Lutron EA LTD
FREEPHONE: 0800 282107 (U.K.)
Tel: +44 (0) 207 702 0657
Fax: +44 (0) 207 480 6899
www.lutron.com/europe

Limited Warranty

Lutron EA Ltd. ("Lutron EA") warrants each unit to be free from defects in material and workmanship and to perform under normal use and service. To the extent permitted by law, Lutron EA and Lutron Electronics Co. Inc. ("Lutron") make no warranties or representations as to the units except as set forth herein. This warranty shall run for a period of one year from the date of purchase and Lutron's obligations under this warranty are limited to remedying any defect, replacing any defective part or replacement (at Lutron EA's sole option) and shall be effective only if the defective unit is shipped to Lutron EA postage prepaid within 12 months after purchase of the unit. Repair or replacement of the unit does not affect the expiry date of the warranty. This warranty does not cover damage or deficiencies due to abuse, misuse, inadequate wiring or insulation or use or installation other than in accordance with instructions accompanying the unit. To the extent permitted by law, neither Lutron EA nor Lutron shall be liable for any other loss or damage including consequential or special loss or damages, loss of profits, loss of income, or loss of contracts arising out of or relating to the supply of the unit or the use of the unit and the purchaser assumes and will hold harmless Lutron EA and Lutron in respect of all such loss or damage. Nothing in this warranty shall have the effect of limiting or excluding Lutron EA's or Lutron's liability for fraud or for death or personal injury resulting from its own negligence, or any other liability, if and to the extent that the same may not be limited or excluded as a matter of law. **This warranty does not affect the statutory rights of consumer purchasers of this product.** Although every attempt is made to ensure that catalogue information is accurate and up-to-date, please check with Lutron EA before specifying or purchasing this equipment to confirm availability, exact specifications, and suitability for your application. Domestic and International patent(s) pending. Lutron is a registered trademarks in the United Kingdom and the Community Trademark System and Lyneo is a trademark of Lutron Electronics Co., Inc. © 2005 Lutron Electronics Co., Inc.

Installation

1 **WARNING:** Turn power OFF at MCB (circuit breaker) or remove fuse.

2 Remove switch mounting screws. Remove switch from wall.
Note: DO NOT disconnect wires from the switch.

Caution: Verify power to each switch is OFF before proceeding.

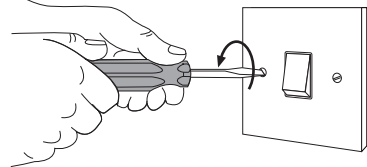

3 Tag the wire(s).

Single-Location control

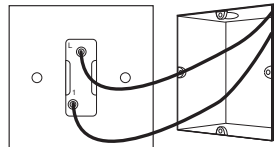

One switch controlling a light fixture.
No tagging is needed.
This switch will be a 1-way. The switch will have insulated wires connected to two terminals.
See Step 6a when wiring.

Two-Location control

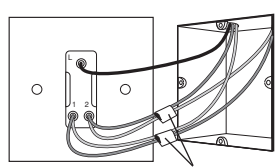

Two switches controlling a light fixture.
TAPE the two wires connected to the terminal labeled 1 together for identification during wiring. **TAPE** the two wires connected to the terminal labeled 2 together.
Both switches will be 2-way. One switch will have five insulated wires connected to three terminals and the other switch will have three insulated wires connected to three terminals.
To replace a switch connected to three wires, see instructions on reverse.
See Step 6b when wiring.

Important Note:

Your wall switch may have two wires attached to the same screw. Tape these two wires together before disconnecting.

4 Disconnect switch wires.

5 Prepare Dimmer for installation.

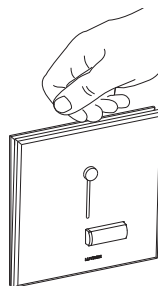

Snap off Front Plate

6 Wiring the control.

Important Wiring Information



WARNING: Permanent damage can be caused by overtightening the terminal screws.

Trim or strip backbox wires to 5 mm. Insert wires fully into the terminals and tighten screws.

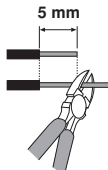

Notes: Dimmer does not require an earth wire. Follow your local and national wiring codes to terminate the earth wire in your backbox. If two wires were taped together, connect both wires to the terminal.

6a - Single-Location Wiring

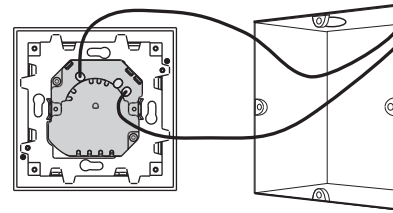

Reference Wiring Diagram

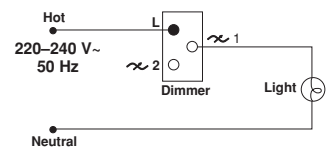

Models: LLSI-502, LNSI-502, LLSM-502, LSSI-501

- Connect one of the insulated wires removed from the switch to terminal L.
- Connect the other insulated wire removed from the switch to either of the \sim terminals.

Note: LSSI-501 only has 2 terminals.

OR

6b - Two-Location Wiring

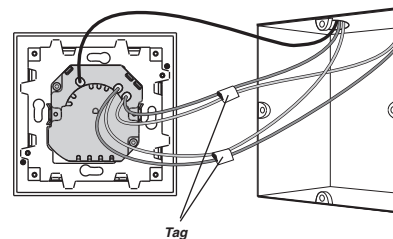

Reference Wiring Diagram

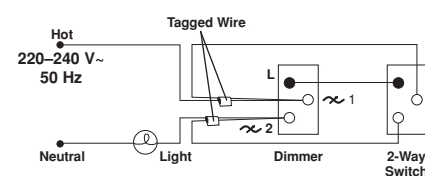

Models: LLSI-502, LNSI-502, LLSM-502

Note: Only one dimmer can be used in a 2-way circuit.

- Connect one pair of Tagged wires removed from the switch to either \sim terminal.
- Connect the remaining pair of Tagged wires removed from the switch to the remaining \sim terminal
- Connect the remaining wire removed from the switch to terminal L.

Note: Dimmer can be wired on the line or load side.

7 Mount and align Dimmer.

Note: Ensure the arrow on the Dimmer is facing UP when installing.

7a - Using the Mounting Claw

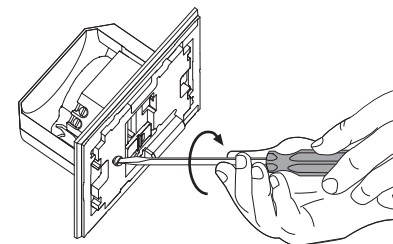

- Rotate each screw 1-2 turns to secure Dimmer to backbox.

Caution - Do not pinch wires.

OR

7b - Using Backbox Screws

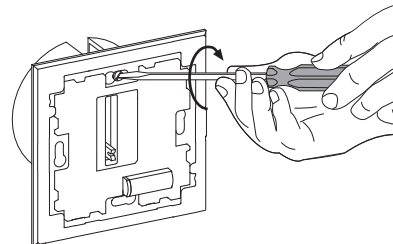

- Claw may be removed.
- Secure Dimmer to the backbox.

Caution - Do not pinch wires. Do not overtighten mounting screws.

8 Snap on Front Plate.



Important Alignment Step

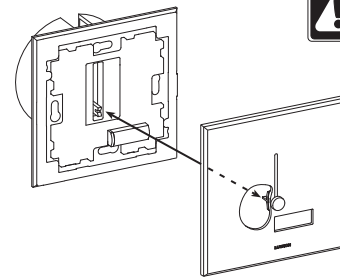

- On the Dimmer, move the slider to the lowest travel position.
- On the Front Plate, move the knob to the lowest travel position.

Note: This ensures proper alignment of the knob and slider.

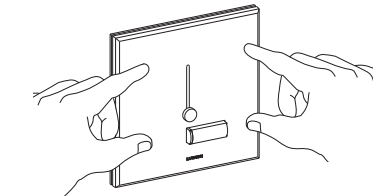

- Press corners to ensure four snaps engaged.
- Move the knob up and down to confirm the knob and slider are properly aligned.

9 Turn power ON at MCB (circuit breaker) or replace fuse.

Operation

Models: LLSI-502
LNSI-502
LLSM-502

Dimming Knob

- Slide up to brighten.
- Slide down to dim.

Status Light

- Bright when lights are ON.
- Dim when lights are OFF.
- LLSI and LLSM models only.

Model: LSSI-501

Dimming Knob

- Slide up to brighten.
- Slide down to dim.
- Click at bottom to turn OFF.

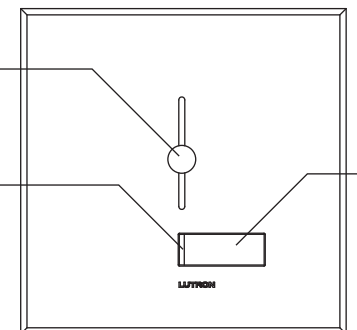

Preset / OFF Button

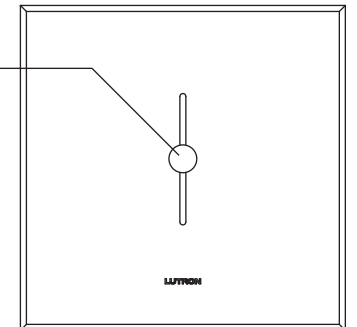

Problems

If your Dimmer does not work, check that the light bulb has not burned out before contacting Lutron Technical Assistance.

Preset Dimmer
Incandescent/Halogen 240 V
LLSI-502, LNSI-502
Rated at: 220-240 V~ 50 Hz 40-500 W



Incandescent/Halogen 240 V / Magnetic Low Voltage
LLSM-502
Rated at: 220-240 V~ 50 Hz 40-500 VA



Slide To Off Dimmer
Incandescent/Halogen 240 V
LSSI-501
Rated at: 220-240 V~ 50 Hz 40-500 W



Important Notes

Please read before installing.

- WARNING:** Do not use LLSI-502, LNSI-502 or LSSI-501 with magnetic (core and coil) low-voltage transformers or electronic (solid-state) low-voltage transformers.
- Use LLSM-502 only with incandescent loads or magnetic low-voltage transformers with thermally fused primary.
- CAUTION:** To avoid overheating and possible damage to other equipment, do not use to control receptacles, fluorescent lighting fixtures, motor-operated or transformer-supplied appliances.
- Turn power OFF at MCB (circuit breaker) before performing any routine maintenance or servicing of lighting circuit.
- For new installations, install a test switch before installing the Dimmer to verify no short in the wiring.
- Protect Dimmer from dust and dirt when painting or during construction.
- Only one Dimmer can be used in a 2-way circuit.
- Dimmer requires a minimum total lamp wattage of 40 W. Do not exceed the maximum rating of 500 W.
- This Dimmer complies with IEC and EN 60669-2-1.
- Minimum backbox depth is 35 mm.**
- Install in accordance with all national and local electrical codes.
- Operate between 0 °C and 40 °C. For indoor use only.
- Dimmer may not work with dioded lamps.
- It is normal for the Dimmer to feel warm to the touch during operation.
- Clean with a *soft damp cloth only*. **DO NOT** use any chemical cleaners.

Call +852.2104.7733
with any questions or feedback
Monday thru Friday 08:00 – 20:00 CET
Saturday and Sunday 10:00 – 20:00 CET

Visit www.lutron.com/europe
for more product information.

Technical Assistance

If you have questions concerning the installation or operation of this product, call the **Lutron Technical Support Center**. Please provide exact model number when calling.
Lutron GL LTD
Tel: +852-2104-7733
Fax: +852-2104-7633
www.lutron.com/europe

Limited Warranty

For a period of one year from the date of purchase, Lutron warrants each new standard wallbox unit to be free from manufacturing defects. Lutron will, at its option, repair or provide a replacement for any defective unit that, in Lutron's opinion, has been installed and operated pursuant to Lutron's product specifications and the applicable provisions of the Electricity Ordinance (Chapter 406 of the Laws of Hong Kong) and any subsidiary legislation and of the Safety Standards of Underwriters Laboratories. Lutron's obligations under this warranty are limited to repairing or providing a replacement for any defective unit that, within one year after purchase, is returned to the place of purchase or mailed, postage pre-paid, to the Lutron Technical Support Center, 7200 Suter Rd., Coopersburg, PA 18036-1299.
This warranty is in lieu of all other express warranties. All implied warranties, including implied warranties of merchantability and of fitness for a particular purpose, are limited to one year from date of purchase. This warranty does not cover: the cost of installation, removal or reinstallation; damage resulting from misuse, abuse, or improper or incorrect repair; damage from improper wiring or installation; or incidental or consequential damages. Lutron's liability on any claim for damages arising out of or relating to the manufacture, sale, installation, delivery, or use of the wallbox unit is limited to the purchase price of the unit.
Except in respect of loss or damage caused by the fraud of Lutron or personal injury or death resulting from Lutron's negligence, in no event will Lutron or any other seller be liable or responsible for any (i) consequential or special damages, (ii) repair work undertaken without Lutron's prior consent, (iii) ancillary equipment not furnished by Lutron which is attached to or used in connection with the wallbox unit, all such equipment being expressly excluded from this warranty, or (iv) any damage to the wallbox unit resulting from the use of ancillary equipment not furnished by Lutron for use with the wallbox unit.
This warranty provides specific legal rights and this warranty and limitations on liability apply to the maximum extent permitted by law. Contact the Lutron Technical Support Center at the numbers provided below with questions concerning the installation or operation of this product or this Warranty. Please provide the exact model number when calling.
Although every attempt is made to ensure that catalogue information is accurate and up-to-date, please check with Lutron before specifying or purchasing this equipment to confirm availability, exact specifications, and suitability for your application.
Domestic and International patent(s) pending.
Lutron is a registered trademark in the United Kingdom and the Community Trademark System and Lyneo is a trademark of Lutron Electronics Co., Inc.
© 2005 Lutron Electronics Co., Inc.

Installation

1 **WARNING:** Turn power OFF at MCB (circuit breaker) or remove fuse.

2 Remove switch mounting screws. Remove switch from wall.
Note: DO NOT disconnect wires from the switch.

Caution: Verify power to each switch is OFF before proceeding.

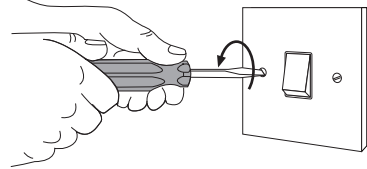

3 Tag the wire(s).

Single-Location control

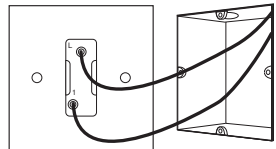

One switch controlling a light fixture.
No tagging is needed.
This switch will be a 1-way. The switch will have insulated wires connected to two terminals.
See Step 6a when wiring.

Two-Location control

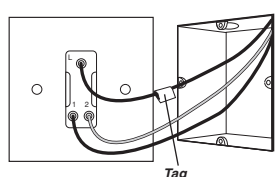

Two switches controlling a light fixture.
TAG the wire connected to the terminal labeled L or LINE for identification during wiring. Both switches will be 2-way. Each switch will have insulated wires connected to three terminals. To replace a switch connected to five wires, see instructions on reverse.
See Step 6b when wiring.

Important Note:

Your wall switch may have two wires attached to the same screw. Tape these two wires together before disconnecting.

4 Disconnect switch wires.

5 Prepare Dimmer for installation.

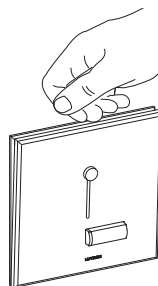

Snap off Front Plate

6 Wiring the control.

Important Wiring Information



WARNING: Permanent damage can be caused by overtightening the terminal screws.

Trim or strip backbox wires to 5 mm. Insert wires fully into the terminals and tighten screws.

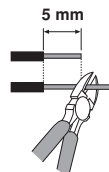

Notes: Dimmer does not require an earth wire. Follow your local and national wiring codes to terminate the earth wire in your backbox. If two wires were taped together, connect both wires to the terminal.

6a - Single-Location Wiring

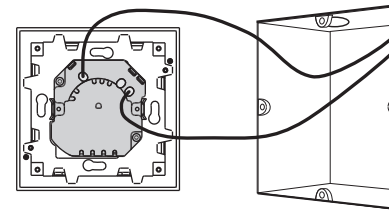

Reference Wiring Diagram

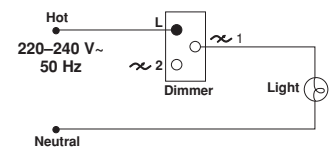

Models: LLSI-502, LNSI-502, LLSM-502, LSSI-501

- Connect one of the insulated wires removed from the switch to terminal L.
- Connect the other insulated wire removed from the switch to either of the ~ terminals.

Note: LSSI-501 only has 2 terminals.

OR

6b - Two-Location Wiring

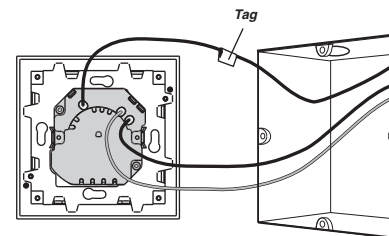

Reference Wiring Diagram

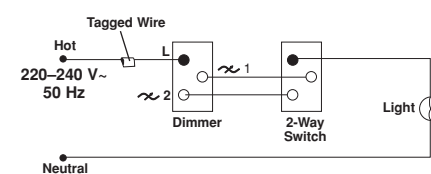

Models: LLSI-502, LNSI-502, LLSM-502

Note: Only one dimmer can be used in a 2-way circuit.

- Connect the Tagged wire removed from the switch to terminal L.
- Connect one of the remaining wires removed from the switch to either ~ terminal.
- Connect the remaining wire removed from the switch to the remaining ~ terminal.

Note: Dimmer can be wired on the line or load side.

7 Mount and align Dimmer.

Note: Ensure the arrow on the Dimmer is facing UP when installing.

7a - Using the Mounting Claw

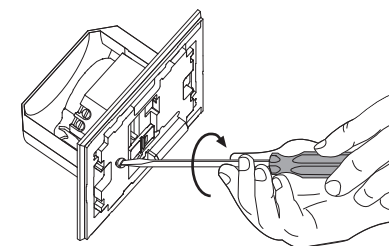

- Rotate each screw 1-2 turns to secure Dimmer to backbox.

Caution - Do not pinch wires.

OR

7b - Using Backbox Screws

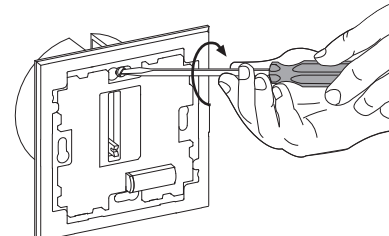

- Claw may be removed.
- Secure Dimmer to the backbox.

Caution - Do not pinch wires. Do not overtighten mounting screws.

8 Snap on Front Plate.



Important Alignment Step

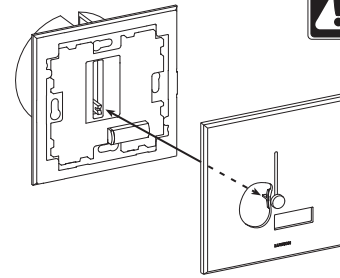

- On the Dimmer, move the slider to the lowest travel position.
- On the Front Plate, move the knob to the lowest travel position.

Note: This ensures proper alignment of the knob and slider.

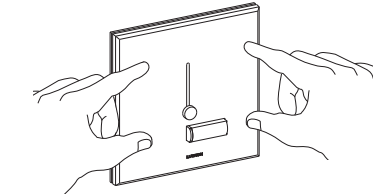

- Press corners to ensure four snaps engaged.
- Move the knob up and down to confirm the knob and slider are properly aligned.

9 Turn power ON at MCB (circuit breaker) or replace fuse.

Operation

Models: LLSI-502
LNSI-502
LLSM-502

Dimming Knob
• Slide up to brighten.
• Slide down to dim.

Status Light
• Bright when lights are ON.
• Dim when lights are OFF.
• LLSI and LLSM models only.

Preset / OFF Button

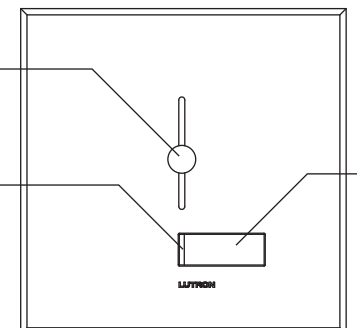

Model: LSSI-501

Dimming Knob
• Slide up to brighten.
• Slide down to dim.
• Click at bottom to turn OFF.

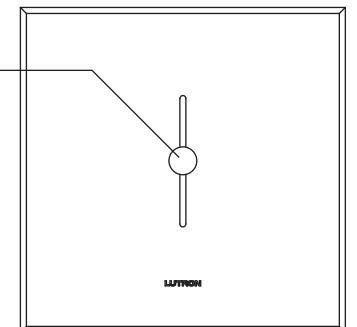

Problems

If your Dimmer does not work, check that the light bulb has not burned out before contacting Lutron Technical Assistance.